

Messachse MA

Electronic Control Systems:Sensors:Force Transducer

Product description

Type	MA
Description	Load pin for shear force measurement
Product description	Load pins are designed to measure static and dynamic shear forces in different applications. Our load pins stand out for: - high accuracy - extremely high overload capacity and fatigue strength - simple, direct installation - built-in measuring signal amplifier - cost effective solution
Order No.	on request

Technical data

Operating voltage	10 ... 36 V DC
Current consumption	30 mA approx.
Measuring range	types from 1t - 300 t
Ovrange limit	200 %
Signal output	4...20 mA or 2,5 ... 7,5 VDC
Class accuracy	1
Temperature comp. zero point	±0,3% / 10K
Temperature comp. over range	±0,5% / 10K
Linearity	1 %
Electrical connection	plug
Mounting position	any

Environmental conditions

Operating temperature	-25 ... +75°C
Storage temperature	-35 ... +80°C
Degree of protection (IP)	IP 65 (IP67 option)
Saltwater-proof	on request

Accessories

Options	special design: salt-water proof special design: extended temperature range -50 ... +85°C
---------	--

Drawing

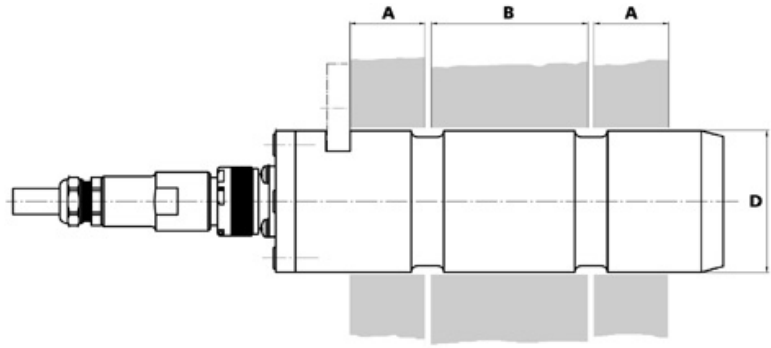

Last / load	A (mm)	B (mm)	D (mm)
von / from 1,0 t ...	12	30	25
bis / up to ... 300 t	55	160	240

other dimensions or load ranges on request